

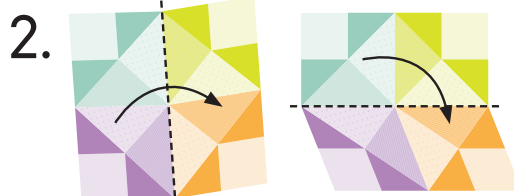

How to fold the chatterbox?



1. Place the printed side face-up on the table



2. Fold the sheet of paper in half, in both directions, to find the middle

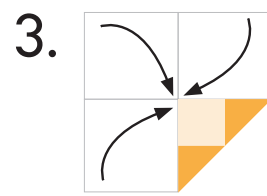

3. Unfold the sheet of paper, turn it over and then fold the four corners towards the center, to get a smaller square.

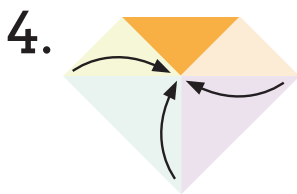

4. Turn over the sheet of paper and fold the four corners towards the center once more, to get an even smaller square

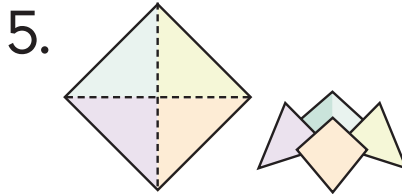

5. Turn over the sheet of paper and lift the four pockets so you can insert your fingers

YOU ARE READY TO PLAY!

How to play?

- + Ask your students to choose a "+" of colour
- + Open the chatterbox in one direction and then the other, while spelling the chosen colour (ex.: if the child selected the "+" blue, open the chatterbox in one direction when saying the letter "b", in the other direction when saying the letter "l", and so on for the letters "u" and "e".)
- + Invite your students to look inside and ask them to select an image
- + Invite them to lift the image and read the question they have to answer